



HERITAGE HARBOUR SOUTH CDD

CHORD GRASS BED REHAB LOCATIONS AND AREAS

LAKE NUMBER	CHORD GRASS BED AREA	REHAB TIMETABLE
L-1	100	#1
L-11	4650	#1
L-31	11000	#1
L-34	15000	#1
L-38	4100	#1
L-44		#1
L-50	15000	#1
L-51	13750	#1
TOTAL	63600 (1.46 ACRES)	
L-5	15000	#2
L-7	8400	#2
L-8	10800	#2
L-12	9000	#2
L-20	18000	#2
L-32	8500	#2
L-35	13000	#2
L-53	2700	#2
TOTAL	85400 (1.96 ACRES)	
L-4	3900	#3
L-13	650	#3
L-26	5000	#3
L-28	2800	#3
L-30	6900	#3
TOTAL	19250 (0.44 ACRES)	

TIMETABLE #1 = 2012
 TIMETABLE #2 = 2013
 TIMETABLE #3 = 2014

LEGEND

- █ CHORD GRASS BED REHAB TIMETABLE #1
- █ CHORD GRASS BED REHAB TIMETABLE #2
- █ CHORD GRASS BED REHAB TIMETABLE #3

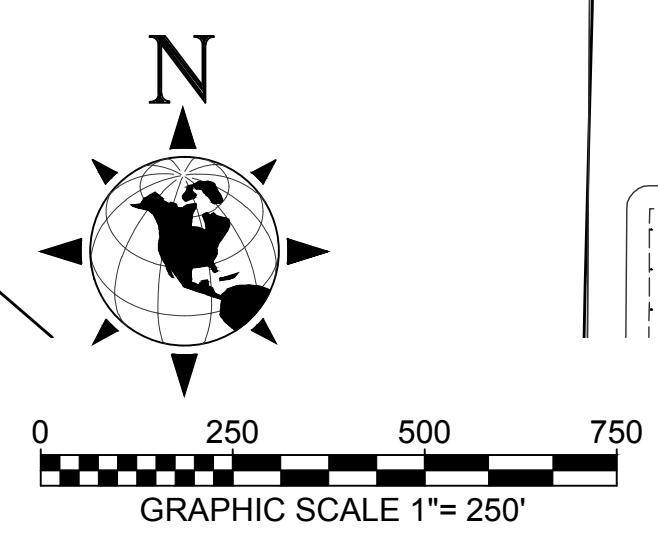

PREPARED FOR:
Heritage Harbour
 South Community Development District
 513 Northeast 13th Avenue
 Fort Lauderdale, Florida 33301

Morris-Riley
 Development Management LLC
 4195 Tamiami Trail South, #113, Venice, Florida 34293 941-228-4729

NO.	DATE	REVISION DESCRIPTION	BY

DATE: 1/5/12
 PROJECT: HH
 DRAWING: CHORD GRASS BED REHAB
 DRAWN DES: MATTHEW J. MORRIS
 CHECKED MJM: FL LICENSE NO. 68434

CHORD GRASS BED REHAB EXHIBIT
HERITAGE HARBOUR
 MANATEE COUNTY, FLORIDA

SCALE: 1"=250'
 SEC.-TSP.-RNG.
 SHEET **1** OF **2**



HERITAGE HARBOUR SOUTH CDD

CHORD GRASS BED REHAB LOCATIONS AND AREAS

LAKE NUMBER	CHORD GRASS BED AREA	REHAB TIMETABLE
L-1	100	#1
L-11	4650	#1
L-31	11000	#1
L-34	15000	#1
L-38	4100	#1
L-44		#1
L-50	15000	#1
L-51	13750	#1
TOTAL	63600 (1.46 ACRES)	
L-5	15000	#2
L-7	8400	#2
L-8	10800	#2
L-12	9000	#2
L-20	18000	#2
L-32	8500	#2
L-35	13000	#2
L-53	2700	#2
TOTAL	85400 (1.96 ACRES)	
L-4	3900	#3
L-13	650	#3
L-26	5000	#3
L-28	2800	#3
L-30	6900	#3
TOTAL	19250 (0.44 ACRES)	

TIMETABLE #1 = 2012
 TIMETABLE #2 = 2013
 TIMETABLE #3 = 2014

LEGEND

- █ CHORD GRASS BED REHAB TIMETABLE #1
- █ CHORD GRASS BED REHAB TIMETABLE #2
- █ CHORD GRASS BED REHAB TIMETABLE #3

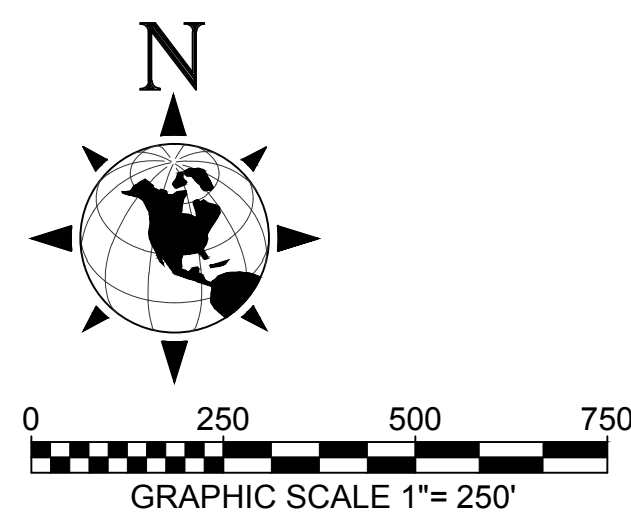

PREPARED FOR:
Heritage Harbour
 South Community Development District
 513 Northeast 13th Avenue
 Fort Lauderdale, Florida 33301

Morris-Riley
 Development Management LLC
 4195 Tamiami Trail South, #113, Venice, Florida 34293 941-228-4729

NO.	DATE	REVISION DESCRIPTION	BY

DATE
1/5/12
 PROJECT
HH
 DRAWING
CHORD GRASS BED REHAB
 DRAWN
DES
 CHECKED
MJM

BY
 MATTHEW J. MORRIS
 FL LICENSE NO. 68434

CHORD GRASS BED REHAB EXHIBIT
HERITAGE HARBOUR
 MANATEE COUNTY, FLORIDA

SCALE
1"=250'
 SEC.-TSP.-RNG.
 SHEET **2** OF **2**