

6067 HERITAGE HARBOUR SOUTH C.D.D.

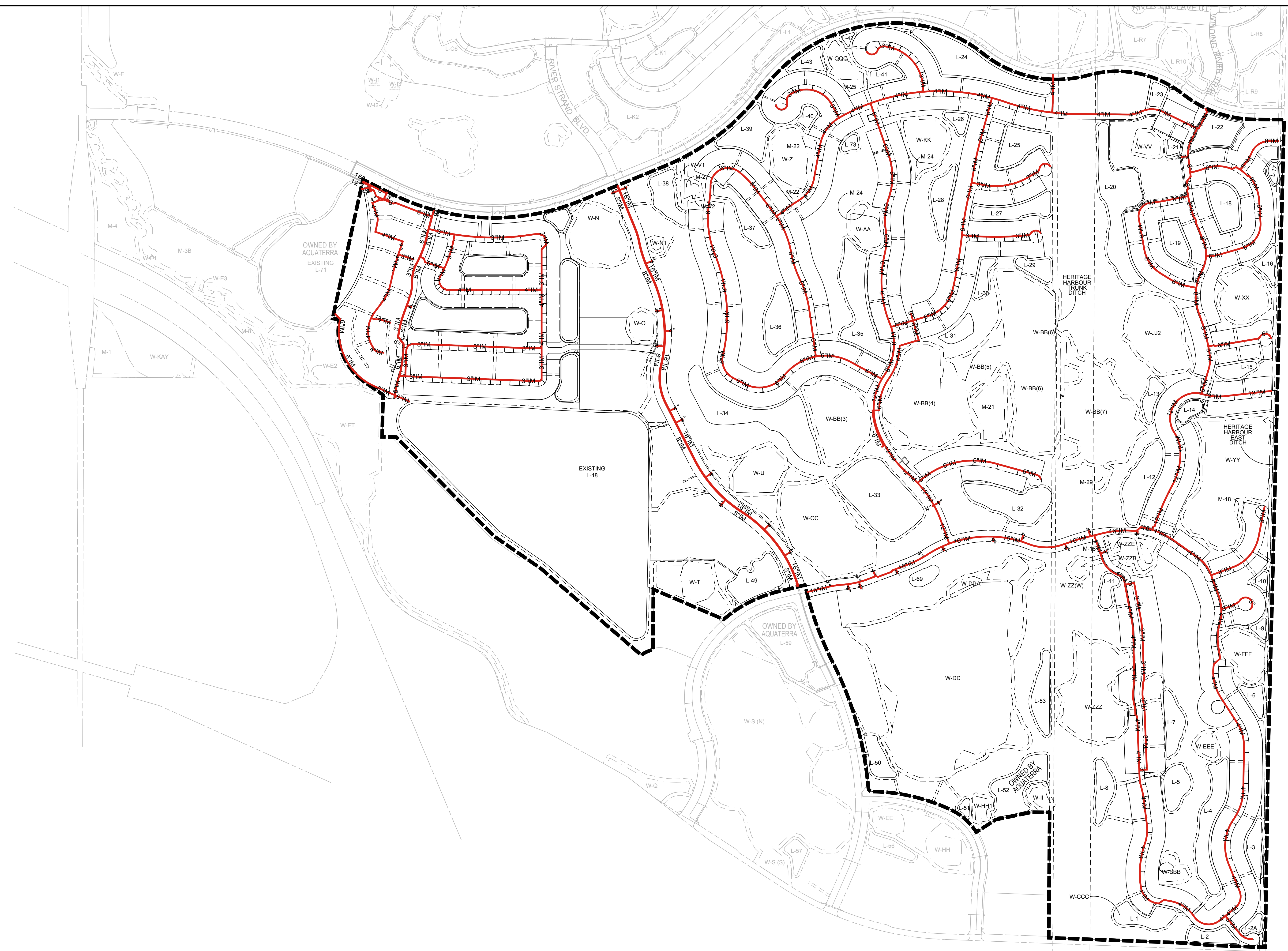
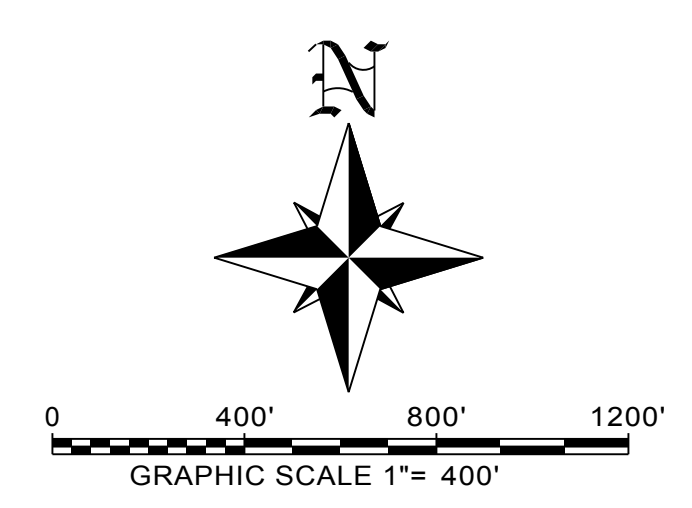

**DESCRIPTION OF IRRIGATION FACILITIES**

- 12,802 LF OF 3" IRRIGATION MAIN
- 17,750 LF OF 4" IRRIGATION MAIN
- 20,711 LF OF 6" IRRIGATION MAIN
- 7,877 LF OF 8" IRRIGATION MAIN
- 3,895 LF OF 12" IRRIGATION MAIN
- 7,559 LF OF 16" IRRIGATION MAIN

**LEGEND**

- DICTRICT OWNED IRRIGATION MAIN
- CDD BOUNDARY

PREPARED FOR:			
<b>LENNAR HOMES, LLC</b>			
7211 PORT HARBOUR PARKWAY BRADENTON, FLORIDA 34212 PHONE: (941) 567-6113 FAX: (941) 567-6115			
NO.	DATE	REVISION DESCRIPTION	BY

**Banks Engineering**  
Professional Engineers, Planners, & Land Surveyors  
FORT MYERS ♦ NAPLES ♦ SARASOTA ♦ CHARLOTTE

1144 TALLEYVALE ROAD, SUITE 105  
SARASOTA, FLORIDA 34243  
PHONE: (941) 360-1618 FAX: (941) 360-6918  
ENGINEERING LICENSE # EB 6469  
SURVEY LICENSE # LB 6690  
WWW.BANKSENG.COM

DICTRICT OWNED IRRIGATION  
**HERITAGE HARBOUR SOUTH CDD**  
MANATEE COUNTY, FLORIDA

DATE	PROJECT	DRAWING	DESIGN	DRAWN	CHECKED	SCALE	SHEET
6-2-09	6061	HMPCDD	SCC	RJE	SCC	1"=400'	1

SHANE C. COOPER, P.E.  
FL. LIC. NO. 53998

SUBMITTER: HERITAGE HARBOUR SOUTH CDD. EXHIBIT: HERITAGE HARBOUR SOUTH CDD. DWG: 31170004.4.301.PN FROM EXHIBIT